

DESCRIPTION

The GR8 is a T8-dedicated lensed troffer designed to offer premium performance in a low profile housing. T8 dedication and optimized lamp to lens spacing provides the best in energy efficiency and optical control. The GR8's shallow, low profile housing is compatible with even highly restrictive plenums. Luminaires are compatible with today's popular ceiling systems.

APPLICATION

The GR8 offers great performance and great quality. The series is an excellent choice for commercial offices, schools, hospitals, retail merchandising and many other applications.

SPECIFICATION FEATURES

A... Construction

Unitized low profile recessed housing is die formed of code gauge prime cold rolled steel with full length stiffeners and mechanical endplate attachment for added strength. Ballast cover is easily removed without tools. Die formed captive lampholder bracket fully encloses lampholder wiring for easy lampholder replacement. Ample KO's are provided for continuous row wiring. Built-in grid-lock feature for safety and convenience. Standard unit is NYC Approved. (No modifications necessary).

B... Electrical**

Ballasts are CBM/ETL Class "P" and are positively secured by mounting bolts. Pressure lock lampholders. UL/CUL listed. Suitable for damp locations.

C... Finish

Multistage, iron phosphate pretreatment ensures maximum bonding and rust inhibition. Lighting grade baked white enamel finish with premium reflectance for high efficiency.

D... Hinging/Latching

Positive spring loaded cam action steel latches and safety lock T-hinges provide secure, high quality door fit and allow hinging and latching from either side.

E... Frame/Shielding

Heavy gauge flat steel door is die formed with reinforced mitered corners. Housing and door frame assemblies incorporate full length and width mechanical light traps. Light stabilized, acrylic prismatic lens.

Catalog #	Type
Project	
Comments	
Prepared by	Date



2GR82U6T8
2U1-5/8
217
417
2BX40

2' X 2' TROFFER
2 OR 4 LAMPS

General Purpose
 T8 Commercial Troffer

ENERGY DATA

Input Watts:
EB Ballast & STD Lamps
 217 (36)
 2U1-5/8 (61)
 2U6T8 (61)
 417 (63)
 2BX40 (71)

ES Ballast & STD Lamps

217 (45)
 2U1-5/8 (71)
 2U6T8 (71)
 417 (90)
 2BX40 (77)

Luminaire Efficacy Rating

LER = FL-57

Catalog Number: 2GR8-2U6T8

Yearly Cost of 1000 lumens, 3000 hrs at .08 KWH = \$4.21

*Standard G (Grid) Type Fixtures can be field converted by adding trim kits. See Compatibility Section or Consult Factory.

**Reference the lamp/ballast data in the Technical Section for specific lamp/ballast requirements.

***Order FCS-22W-U Flange Kit for installation in drywall ceiling. See options and accessories compatibility section.

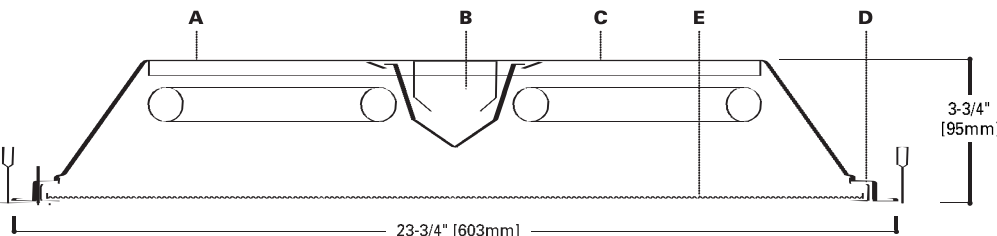

MOUNTING DATA

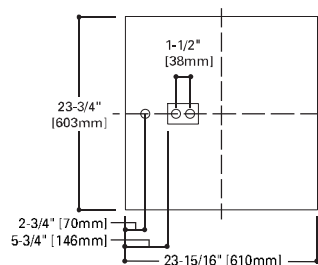

LAMP CONFIGURATIONS

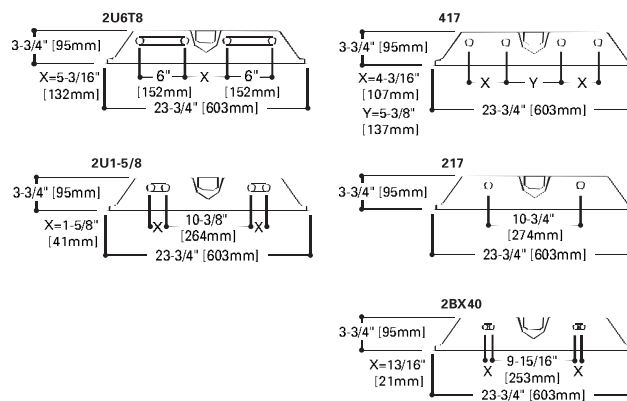

DOOR FRAMES

2GR8
 Flat, White
 Steel (White
 Latches)

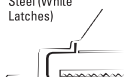

CEILING COMPATIBILITY

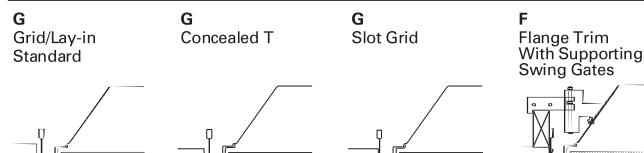

Ceiling Type	Trim Type
Exposed Grid	G
Concealed T	G
Slot Grid	G
Flange	G***



PHOTOMETRICS

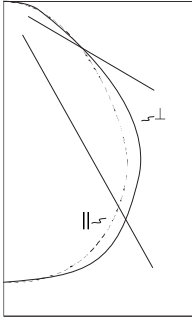

2GR8-2U6T8A
Electronic Ballast
FB31T8/TL735/6
lamps
2600 lumens

Spacing criterion:
(H) 1.2 x mounting
height, (L) 1.3 x
mounting height

Efficiency 69.5%

Test Report:
2GR82U6T8A.IES

LER = FL-57

Yearly Cost of 1000
lumens, 3000 hrs at
.08 KWH = \$4.21

Coefficients of Utilization

rc	Effective floor cavity reflectance																	
	80%				70%				50%		30%		10%		0%			
rw	70	50	30	10	70	50	30	10	50	30	10	50	30	10	50	30	10	0
RCR																		
0	83	83	83	83	81	81	81	81	77	77	77	74	74	74	71	71	71	69
1	77	74	71	69	75	72	70	68	69	67	66	67	65	64	64	63	62	60
2	71	66	62	58	69	64	61	57	62	59	56	60	57	55	58	56	54	52
3	65	59	54	50	64	58	53	50	56	52	49	54	51	48	52	49	47	46
4	60	53	47	43	59	52	47	43	50	46	42	49	45	42	47	44	41	40
5	55	47	42	37	54	47	41	37	45	40	37	44	40	36	43	39	36	35
6	51	43	37	33	50	42	37	33	41	36	32	40	35	32	39	35	32	30
7	47	39	33	29	46	38	32	29	37	32	28	36	32	28	35	31	28	27
8	44	35	29	25	43	34	29	25	33	28	25	32	28	25	32	28	24	23
9	40	31	26	22	39	31	25	22	30	25	22	29	25	21	28	24	21	20
10	37	28	23	19	37	28	23	19	27	22	19	27	22	19	26	22	19	18

Zonal Lumen Summary

Zone	Lumens	%Lamp	%Fixture
0-30	1156	22.2	32.0
0-40	1879	36.1	52.0
0-60	3077	59.2	85.2
0-90	3613	69.5	100.0
0-180	3613	69.5	100.0

Typical VCP Percentages

Room Size (Ft.)	Height Along		Height Across	
	8.5'	10.0'	8.5'	10.0'
20 x 20	64	68	60	65
30 x 30	56	61	53	58
30 x 60	47	50	43	46
60 x 30	57	62	56	60
60 x 60	47	50	44	47

Candela

Angle	Along H	45°	Across ⊥
0	1462	1462	1462
5	1461	1459	1464
10	1443	1448	1460
15	1410	1426	1448
20	1360	1389	1421
25	1296	1335	1371
30	1212	1259	1292
35	1108	1159	1201
40	984	1039	1103
45	836	891	985
50	670	734	827
55	522	563	631
60	396	394	443
65	294	259	319
70	216	171	245
75	165	137	198
80	125	118	149
85	67	67	77
90	0	0	0

ORDERING INFORMATION

SAMPLE NUMBER: 2GR8-2U6T8A-120V-EB81-U

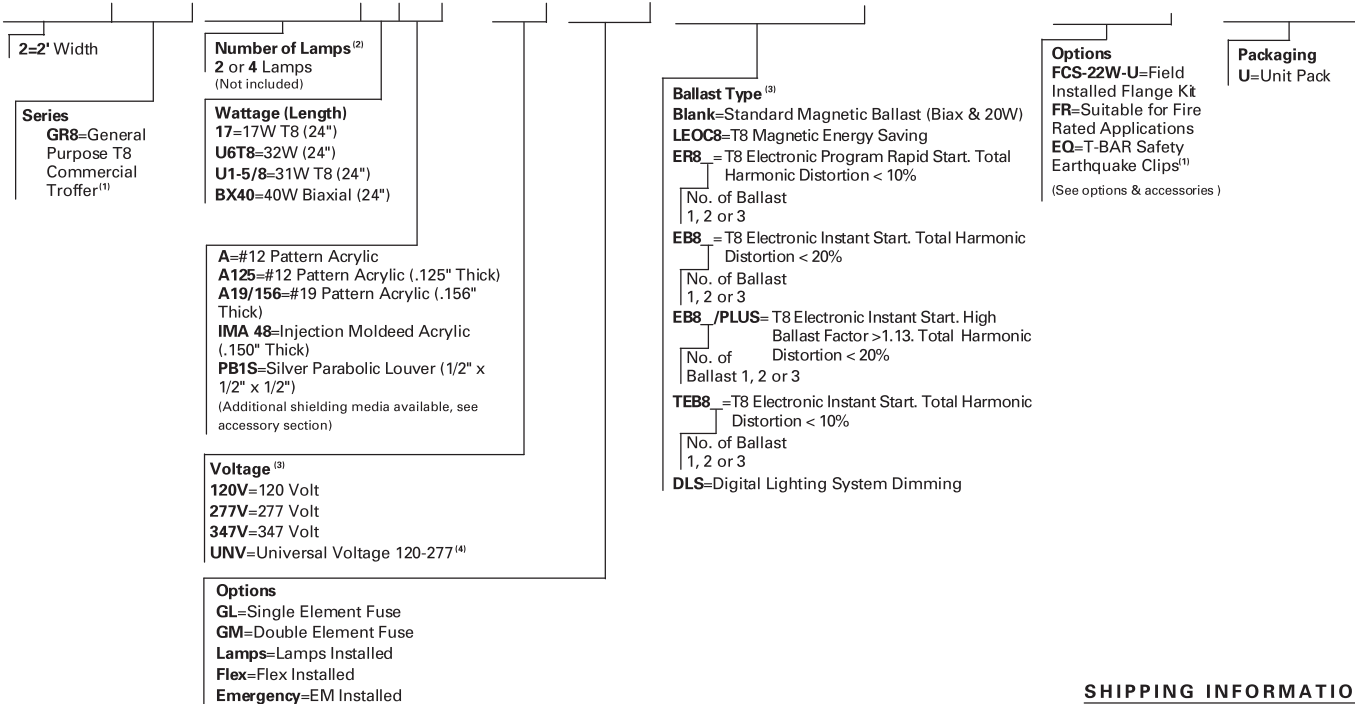

SHIPPING INFORMATION

Catalog No.	Wt.
2GR8-217A	18 lbs.
2GR8-417A	21 lbs.
2GR8-2U6T8A	18 lbs.
2GR8-2U1-5/8A	18 lbs.
2GR8-2BX40A	18 lbs.

NOTES: ⁽¹⁾ An EQ Grid Clip is recommended for all 9/16" ceiling systems. ⁽²⁾ Standard off-center ballast compartment on 3-lamp fixtures. ⁽³⁾ Products also available in non-US voltages and frequencies for international markets. ⁽⁴⁾ Not available when specifying emergencies, voltage must be specific.

For complete product data, reference the Fluorescent Specification binder. Specifications & dimensions subject to change without notice. Consult your Cooper Lighting Representative for availability and ordering information.